

Proposed Footway

Access and footway works approved under planning ref 22/03534/FUL

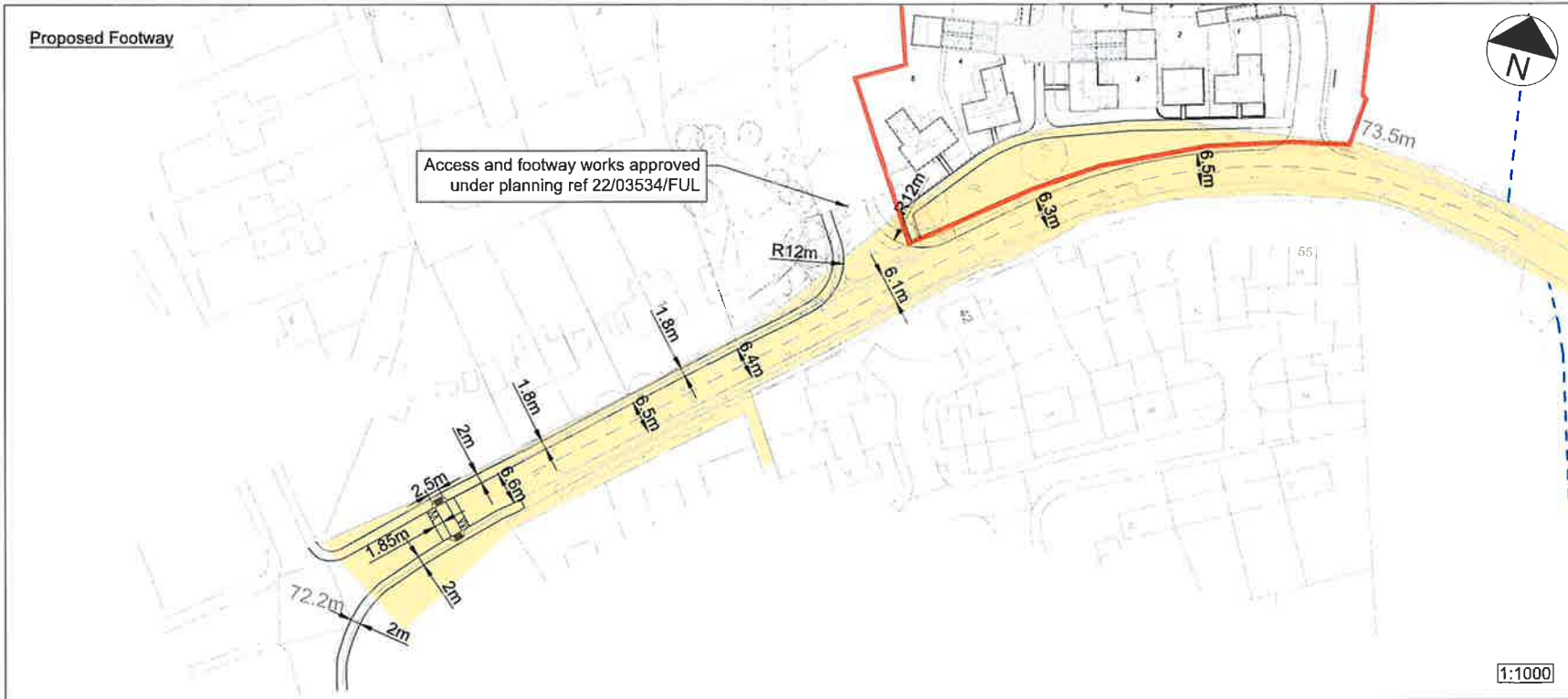

Notes:

1. Do not scale from this drawing. All dimensions are in metres, unless stated otherwise.
2. This drawing is based on the architect's layout by Eric Cole Architecture, drawing number 24.050.100 Rev 3, dated March 2025.
3. The red line boundary is based on the architect's layout by Eric Cole Architecture, drawing number 24.050.100 Rev 3, dated March 2025. The applicant should undertake legal, and title checks to ensure that the red and blue lines are accurate. Rappor will not accept any liability for any inaccuracies in the red and blue line boundaries.
4. The topographical survey was undertaken by BWB Consulting, drawing number GDBF-BWB-00-01-DR-G-0001, dated 30/07/2019.
5. Highway boundary information has been provided by Gloucestershire County Council, 11/04/2018, and has been overlaid by Rappor onto the Ordnance Survey on a best fit basis. The applicant should undertake all necessary checks to ensure all visibility splays and necessary works can be accommodated within the adopted highway of land controlled by the applicant.
6. Ordnance Survey, (c) Crown Copyright 2025. All rights reserved. Licence AC0000813445.
7. Drawing to be read in conjunction with all other drawings. Any discrepancies are to be reported to the engineer 5 working days in advance of undertaking any work.
8. The layout is subject to detailed design, capacity testing, ground investigations & earth modelling, road safety audit, utilities & services and confirmation of land ownership.
9. Use of the drawing does not absolve the client from their responsibilities in regards to health & safety and CDM regulations.

Key:

- Indicative Site Boundary
- Adopted Highway Boundary
- PROW - Public Right of Way
- 1.0m x 43m Pedestrian Visibility Splay
- 1.0m x 28m Pedestrian Visibility Splay to Junction

Pedestrian Crossing Visibility Assessment

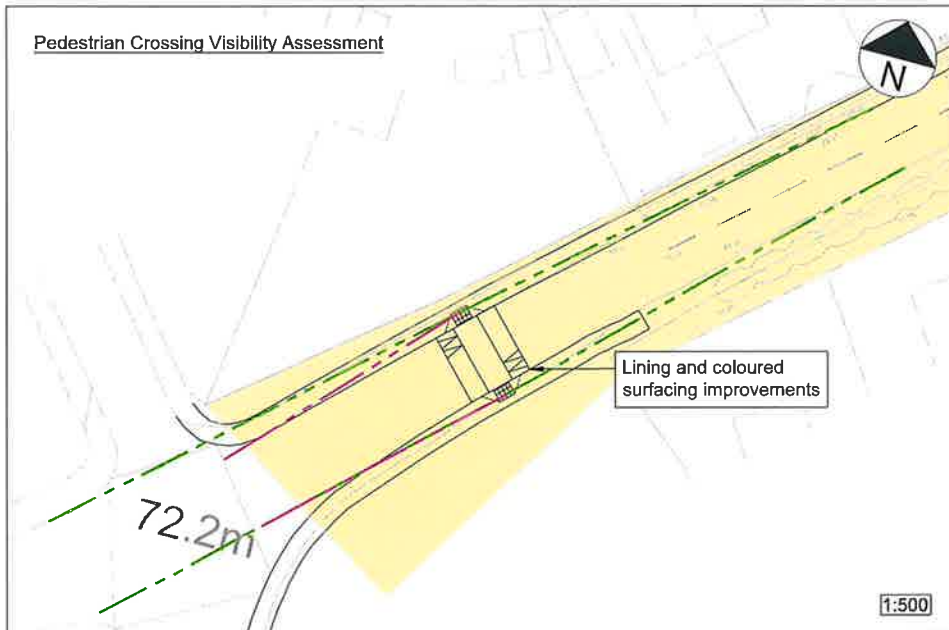

Pedestrian Crossing Improvement

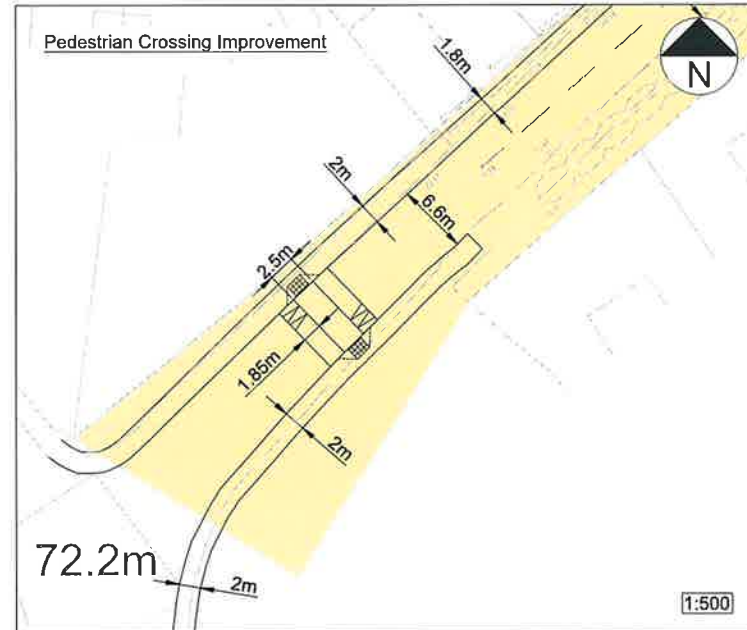

Rev	Date	Details	By	Chkd
P02	14.05.25	Updated Site Layout & Access	SB	MG
P01	15.04.25	Updated Site Layout & Proposed Footway	JL	JNDS

rappor



CLIENT: Gloucester Diocesan Board of Finance

PROJECT: Land at Willersey

TITLE: Proposed Footway Connection

WITH AUTOSLOPE 16/25

SCALE @ A3	DATE	DRAWN	CHECKED	APPROVED
As Stated	05.03.24	SB	JNDS	MG

STATUS: INFORMATION

DRAWING NO	REVISION
241030-RAP-XX-XX-DR-TP-6001	P02